

LIFTING CLAMP for Concrete material (Non-marring type)

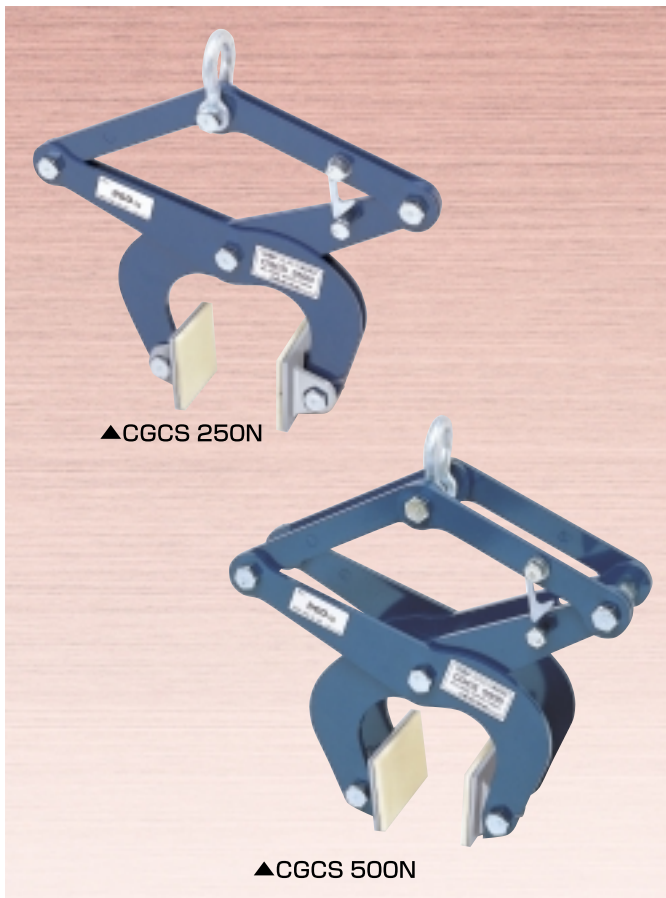

CGCS 250N・500N

For machine use

Ideal clamps for the lifting and handling of reinforced concrete U-shaped gutters, U-shaped flume channels, L-shaped panels, concrete shelf boards.

(Polyurethane pad type)

FEATURES

- The polyurethane lifting pads will not mar the surface of the work piece.
- The clamp can be easily switched between lock and unlock by hooking the hooking plate.
- The clamping force increases in proportion to the weight of the load.

SPECIFICATIONS

Item No.	Rated capacity (kg)	Jaw opening (mm)	Weight (kg)	Remarks
CGCS 250N	250	30~140	7	
CGCS 500N	500	30~140	13	

OPEN LOCK MECHANISM

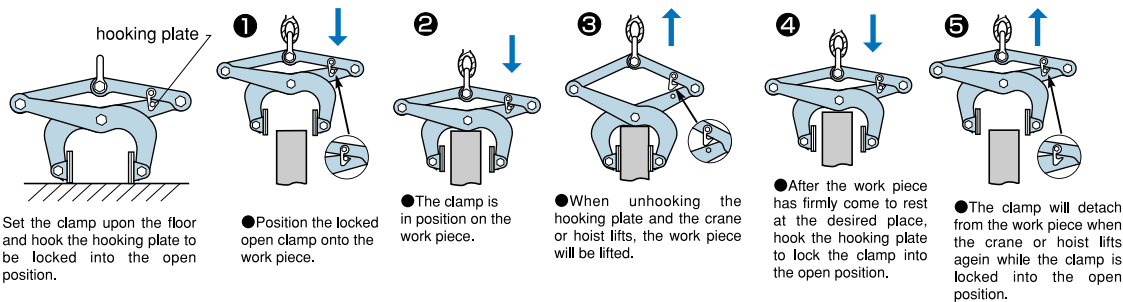

EXAMPLE OF USE



LIFTING CLAMPS FOR CONCRETE

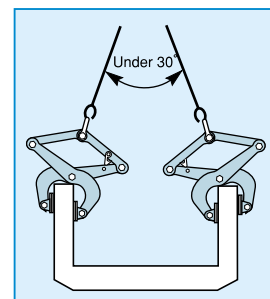
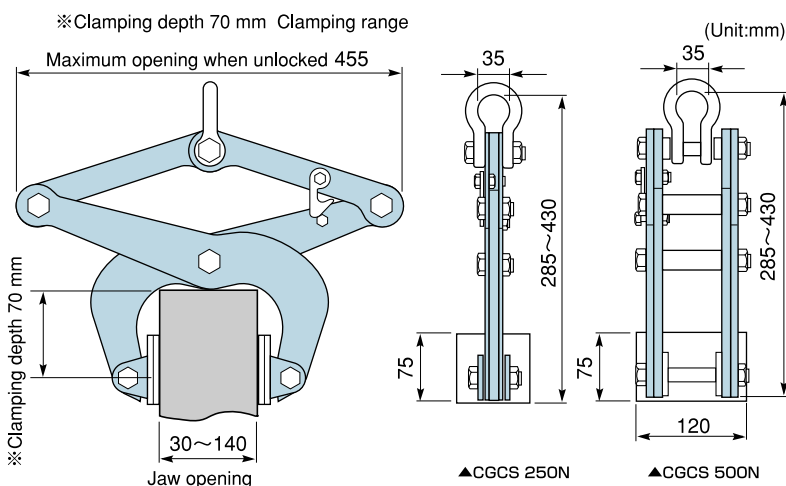

⚠ Always lift work pieces at 2 or more points for safety.

The dimension of ※ indicates when the thickness of the applicable concrete structures is at maximum.